

### Minimum Footprint Dimensions

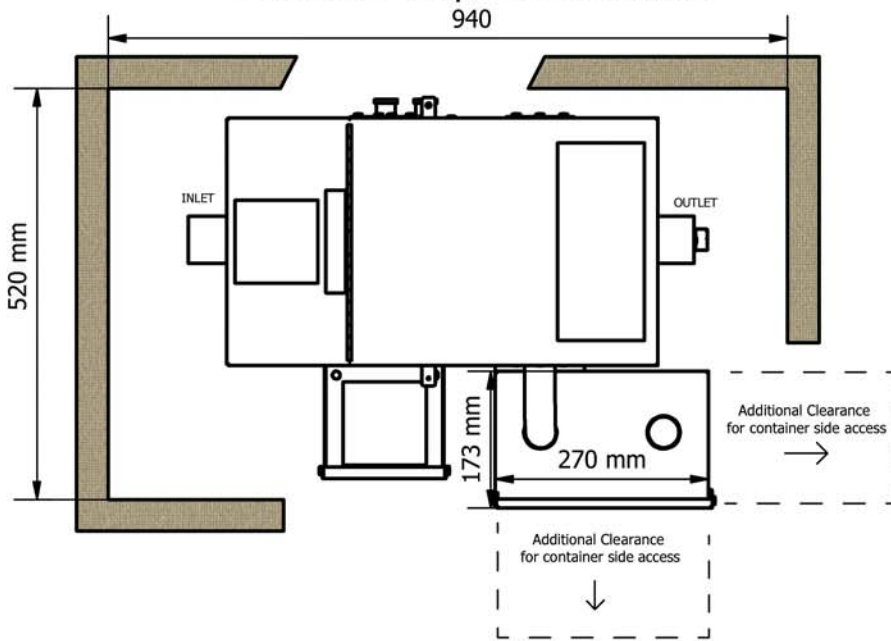

Allow for the minimum clearances shown

Allow additional 150mm length clearance for outlet sampling port where applicable

Grease Collector is front loading/side loading optional. Standard supply is front loading

### TECHNICAL DATA

Weight	31 KG
Material	Exterior, 16 gauge stainless steel, bright finish
Interior	Stainless Steel and Acetal Plastic Components
Maximum Flow Rate	1.25 litres per second
Number of skimming wheels	1 to 3 optional
Solid Strainer Capacity	4 litres
Skimming Rate	12 kg per hour/wheel
Programming/Control	24 hour, 7 day, multi functional digital
Electrical Load	230VAC, 1024 Watts 4.46 AMPS